

TÜRENWERKE

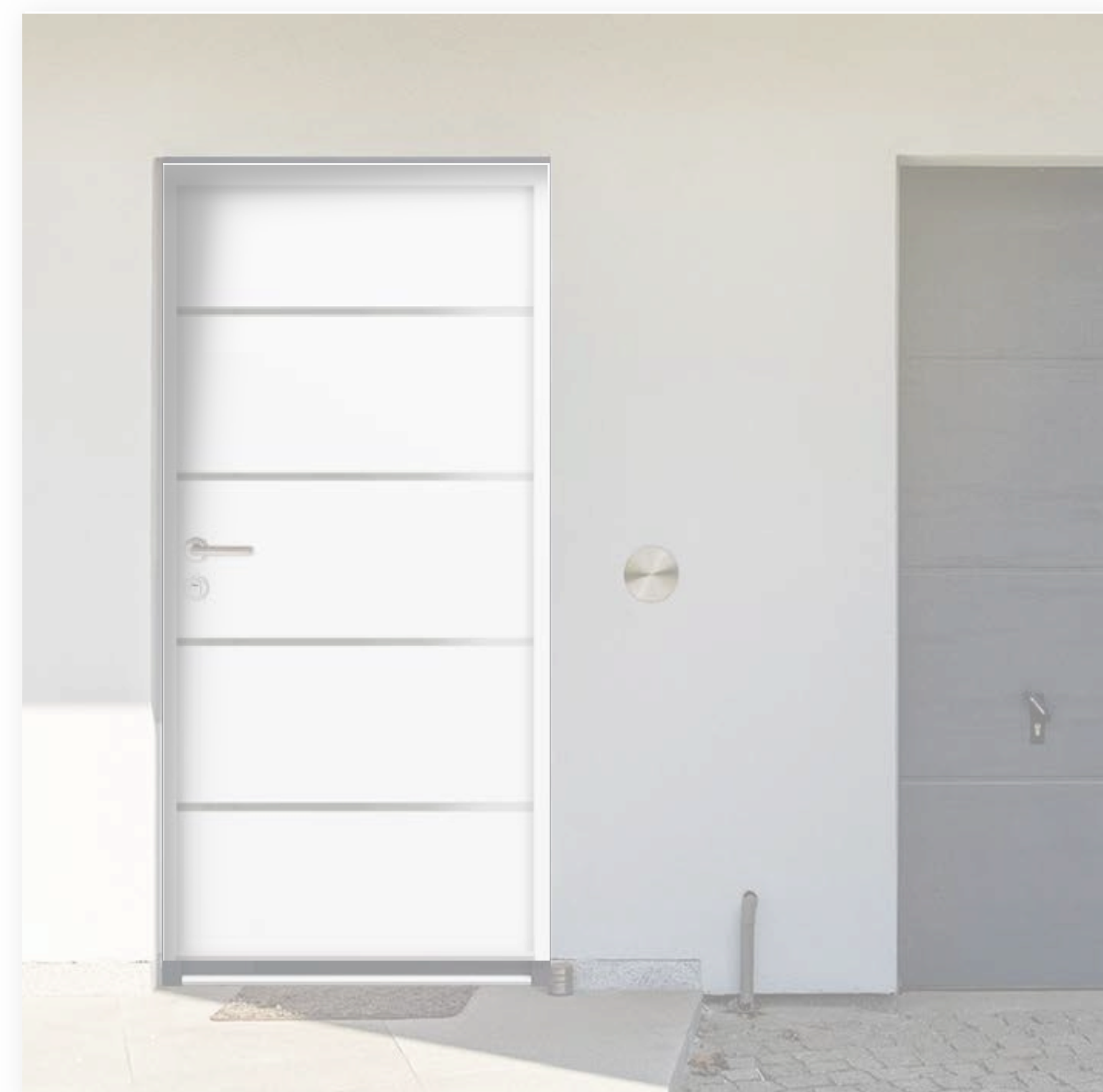

BUDGET EXTERIOR DOORS

NBT56

NBT56

PURPOSE

Exterior and interior doors with the option of glazing. Intended for industrial and commercial facilities as well as technical and utility buildings for private users.

Their advantages include the stable construction of the leaf and frame, resistance to weather conditions, and improved thermal parameters.

ANTHRACITE



WHITE



NBT56

AVAILABLE MODELS



M507 - Anthracite

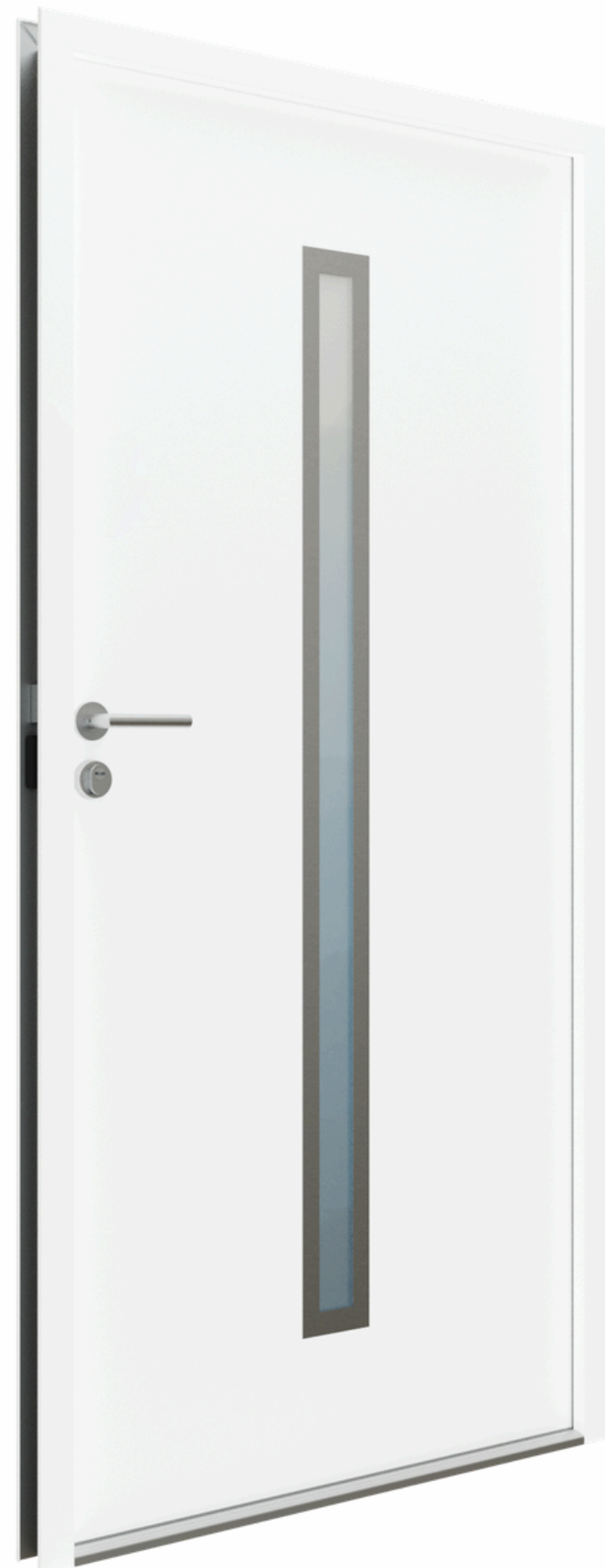

M501 - White



M502 - Anthracite



M504 - White



M505 - Anthracite



M514 - White



K1 - Anthracite

NBT56

DOOR CONSTRUCTION

facing: 0.5 mm galvanized steel sheet, primer-coated

aluminium threshold with gasket

EPS polystyrene insulation

leaf thickness - 56 mm

double-chamber ESG glazing unit

symmetrical steel frame - 70 mm, sheet thickness 1.2 mm

leaf finished at the bottom with a profile (bonded reinforcing channel section)

wooden reinforcement under the hinge

anti-burglary pin

2D hinges - 2 pcs

anti-burglary pin

three-sided rebate - thickness 19 mm

wooden reinforcement block for the lock

mortise lock with handle follower and three bolts

DECLARATION OF PERFORMANCE

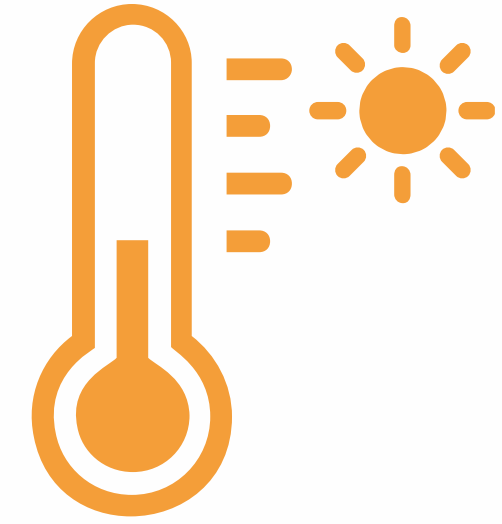

Thermal transmittance

SOLID DOORS

Ud= 1,6 W/(m²·K)

GLAZED DOORS

Ud= 1,8 W/(m²·K)

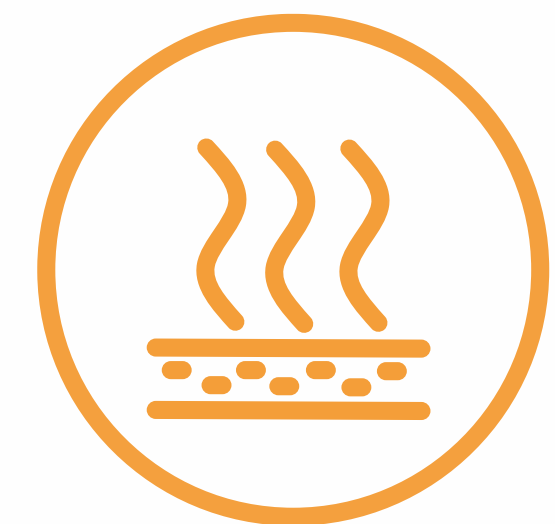

Air permeability

CLASS 2

Essential characteristics	Declared performance	Harmonized technical specification
Resistance to wind load	Class C3	EN 14351-1:2006+A2:2016
Water tightness	NPD Inward-opening Class 2A Outward-opening	
Air permeability	Class 2	
Thermal transmittance	Ud= 1,6 W/(m²·K) Solid doors Ud= 1,8 W/(m²·K) Glazed doors	
Radiation-related properties Solar factor (g)	NPD	
Hazardous substances	Not contain	
Impact resistance	Class 1	

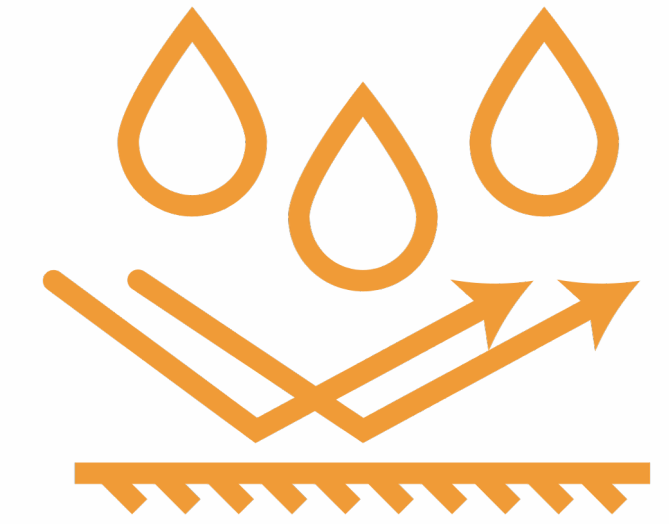

Water tightness

OUTWARD-OPENING
DOORS

CLASS 2A



Resistance to
wind load

CLASS C3

TECHNICAL DRAWINGS

Frame

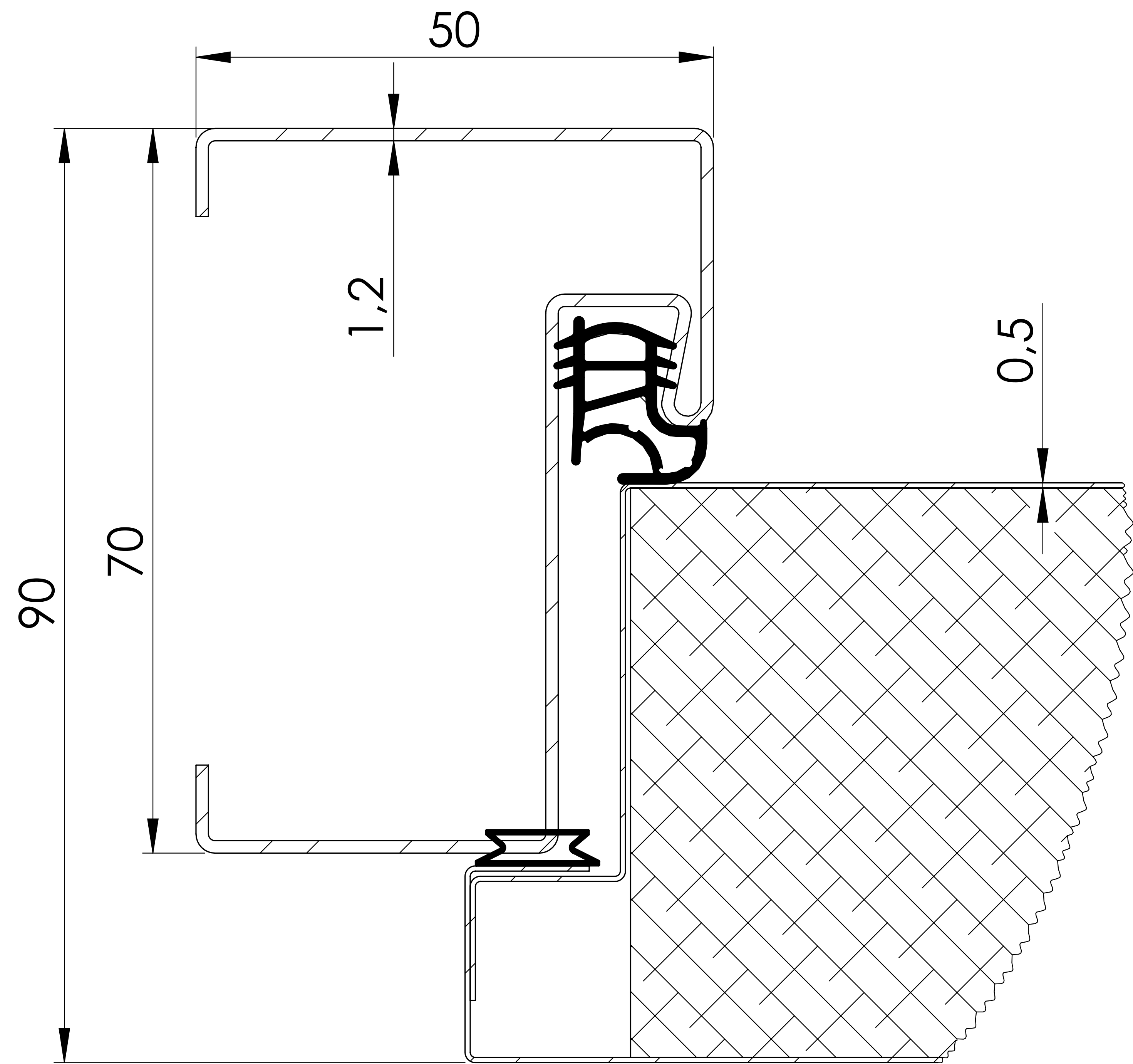

Aluminium threshold with gasket

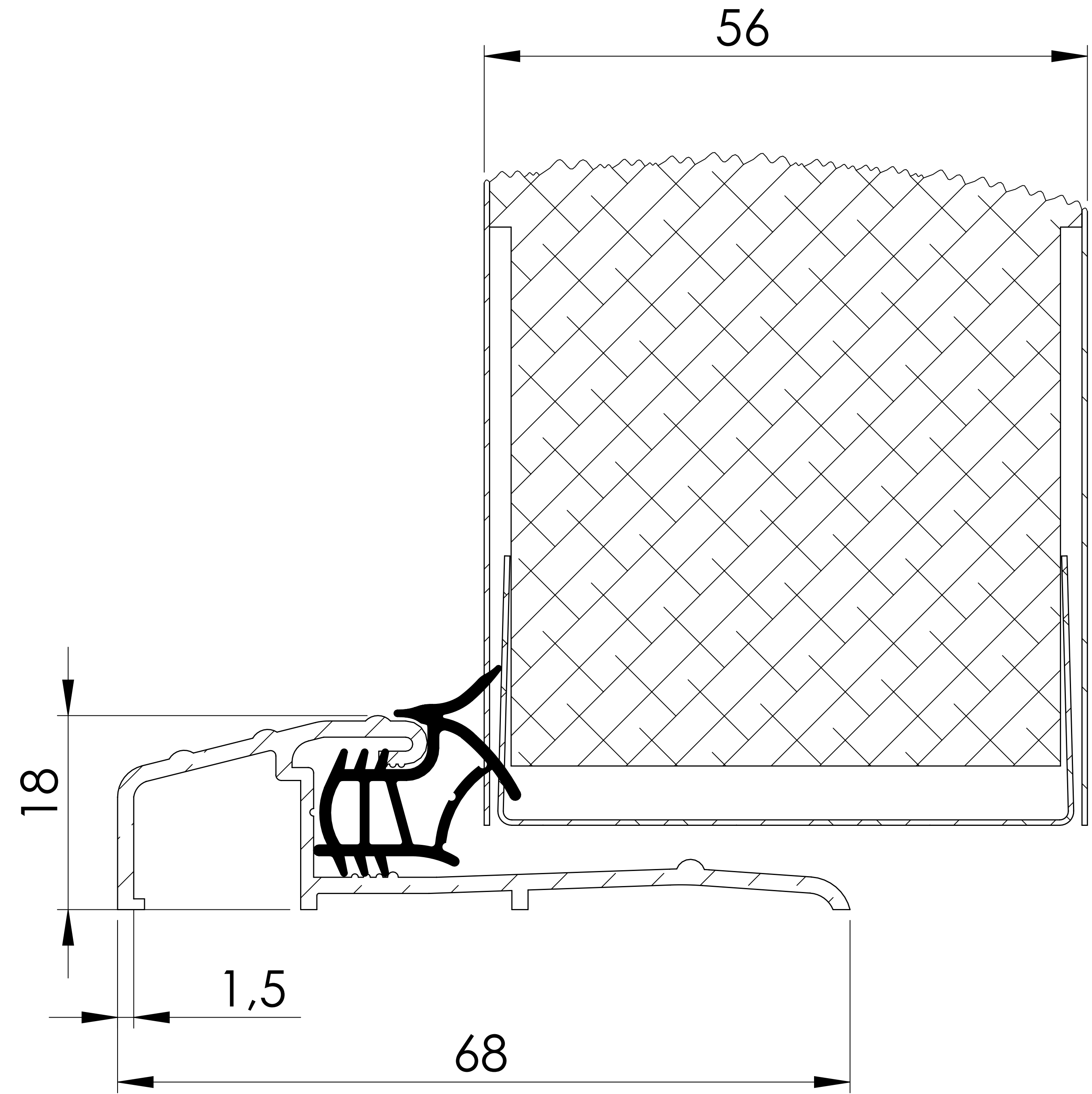

NBT56

DIMENSIONS

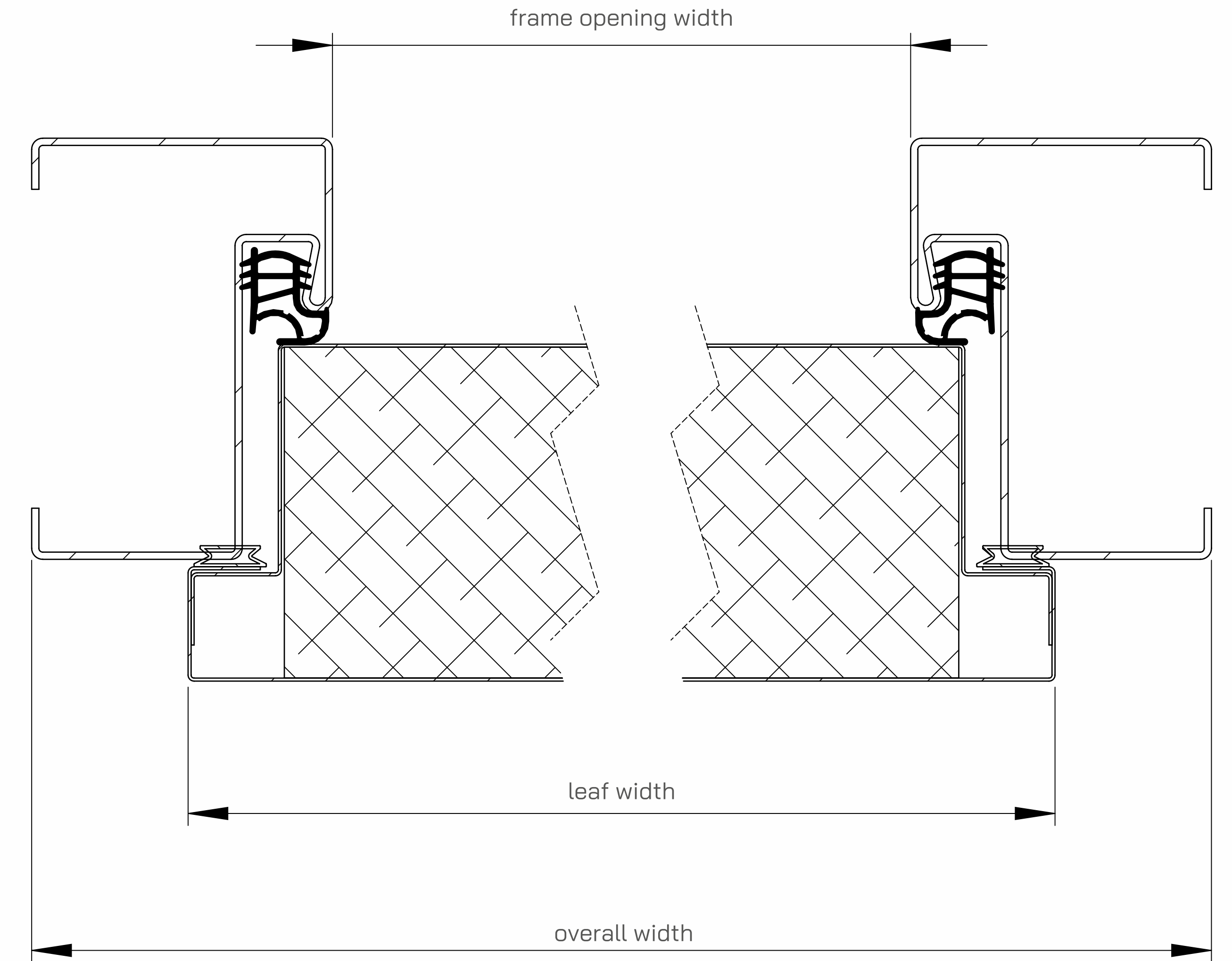
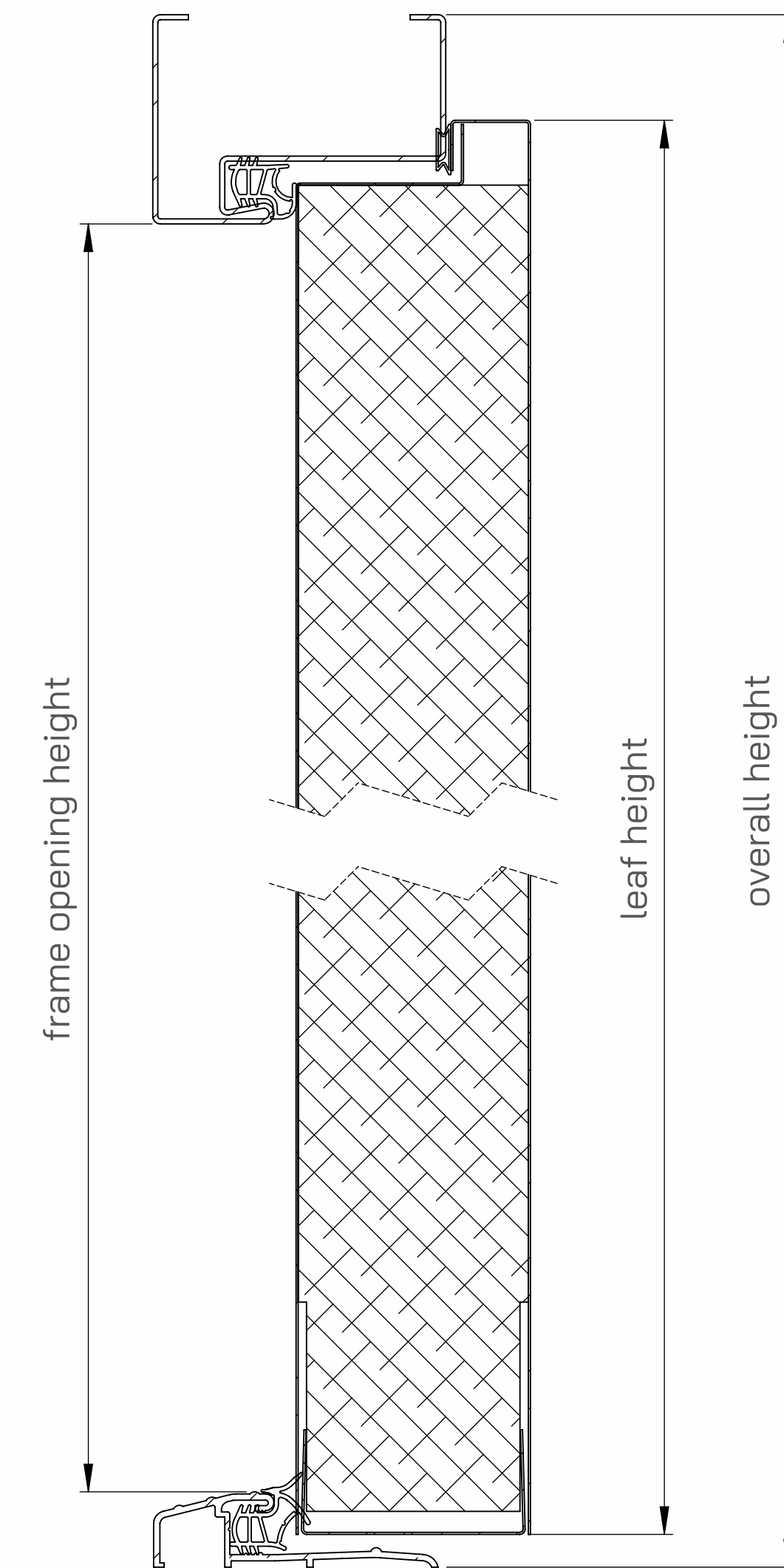
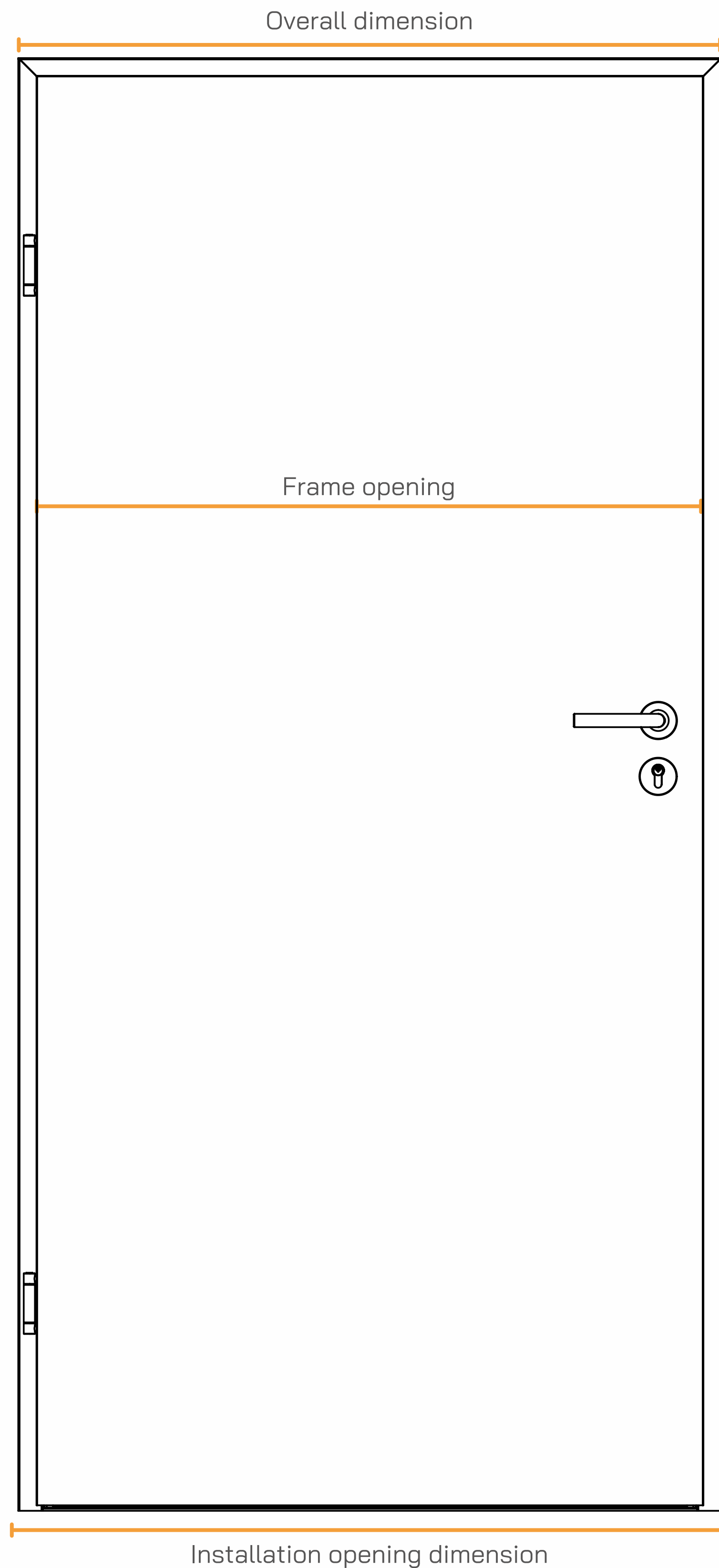

SERIES NBT56	Overall dimension (mm)		Installation opening dimension (mm)		Frame opening (mm)	
	Width	Height	Width	Height	Width	Height
80	900	1900	930	1915	803	1833
80	900	2000	930	2015	803	1933
80	960	2180	990	2195	863	2083
90	1000	2000	1030	2015	903	1933
90	1000	2100	1030	2115	903	2033
100	1100	2100	1130	2115	1003	2033

NBT56 GLAZING

The use of modern glazing technologies makes it possible to combine an attractive door appearance with high performance parameters. We offer solutions that not only brighten interiors but also increase the level of security and energy efficiency.

Triple-glazed unit: equipped with a warm spacer frame ensuring good thermal insulation

Tempered glass (ESG): increased resistance to mechanical damage and safe breakage

Available glazing colours: TRANSPARENT, SATIN, GRAPHITE GREY, REFLEX GREY



The actual appearance and effect of the glazing depend on the colour scheme, light intensity and the character of the surroundings.



TRANSPARENT



SATIN



GRAPHITE GREY



REFLEX GREY

NBT56 FITTINGS

Handle on both sides

Double-sided handle with an elegant round stainless-steel escutcheon. Model without security protection – ideal for interiors where simplicity and functionality matter.

01

SET ECO

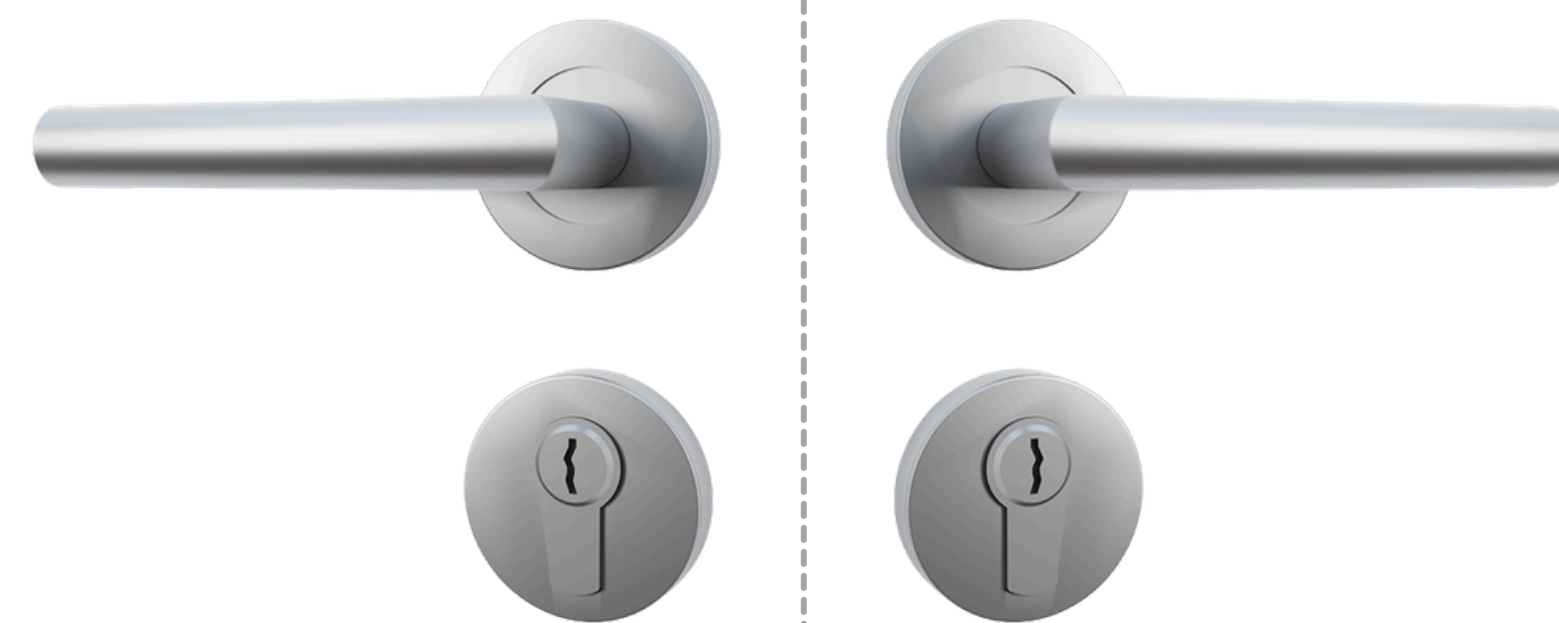

Exterior side

Interior side

02

SET WITH SECURITY
ESCUTCHEON

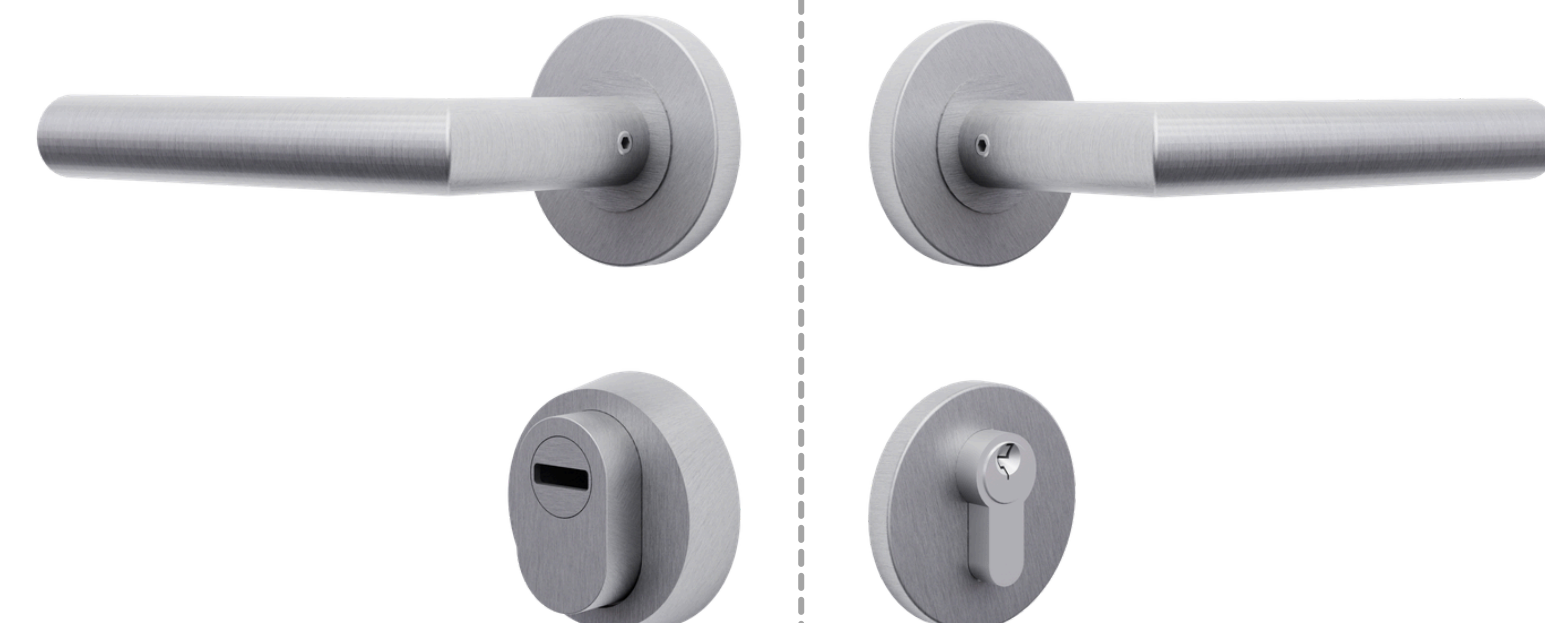

Exterior side

Interior side

NBT56 LOCK

Mortise lock with handle follower and three bolts

Reliable mortise lock with handle follower for exterior and interior doors. Intended for mortise installation, it ensures secure locking and compatibility with popular fitting sets.

Type: mortise, handle follower

Backset: 72/50 mm

Cylinder: with three keys

Cylinder length: 30/50 mm

An anti-panic cylinder is also available.



NBT56 HINGES

Durable and safe hinges for all conditions

Solid and functional hinges ensure durability and precise fitting of the leaf to the frame.

Number of hinges: 2 pcs

Type: three-part

Hinge diameter: 16 mm

Adjustment: 2D (gasket pressure and side adjustment)

Anti-burglary pins: 2 pcs

protection against hinge pin removal



NBT56

PACKAGING

We take care of every stage of order fulfillment, from production to delivery of the door to the customer. Our packaging standards ensure not only safety during transport, but also preserve the product's high aesthetics and quality. Every detail, from the choice of materials to the method of protection, is carefully considered to meet the expectations of the most demanding customers.

Doors are packed in stretch film with gaskets included. The handle is packed separately. A pallet holds from 16 to 24 doors, depending on the model and size.

Door weight: from 25 kg to 38 kg (depending on size)

Pallet dimensions: 215 × 115 cm*

**Pallet dimensions may vary depending on the door size.*

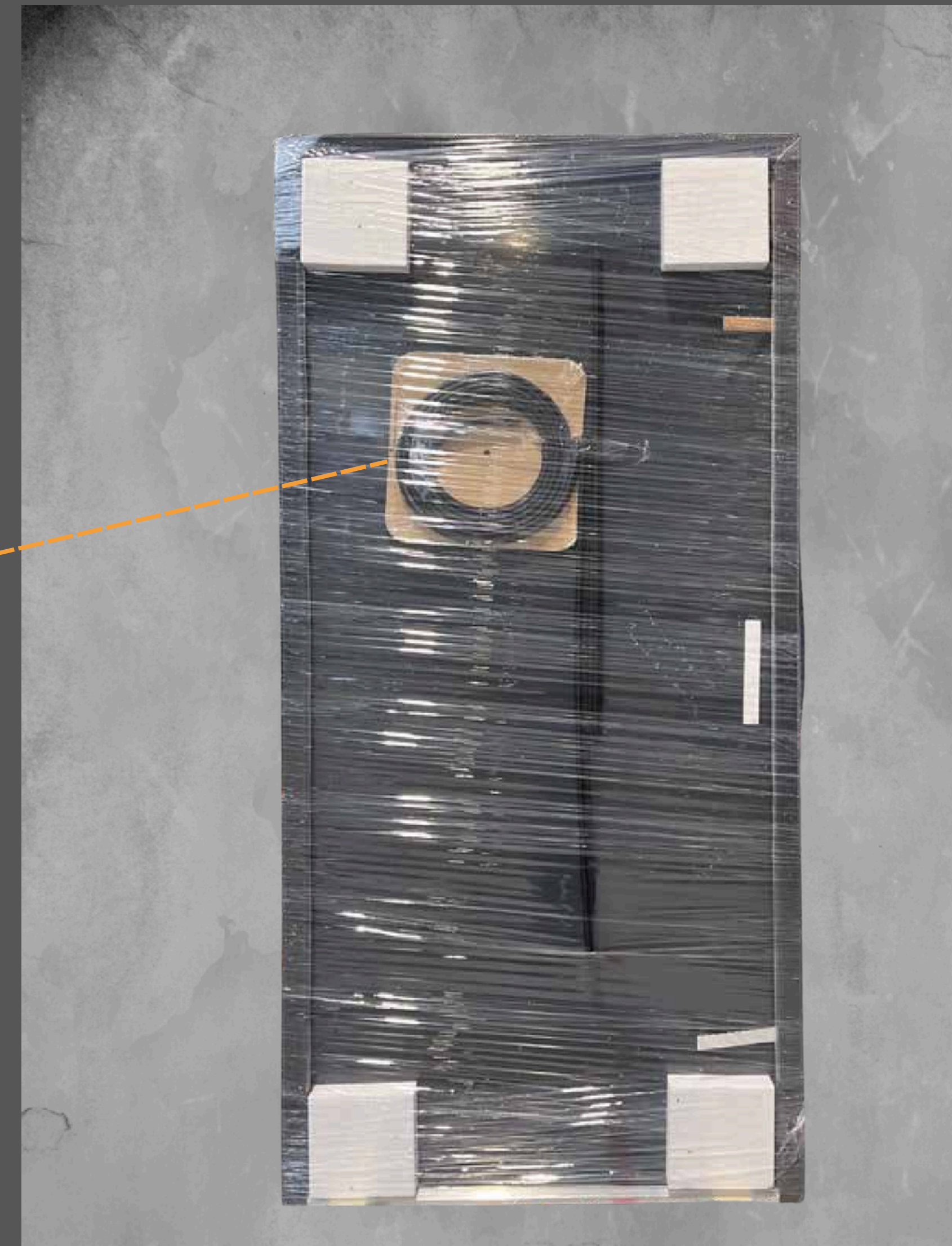
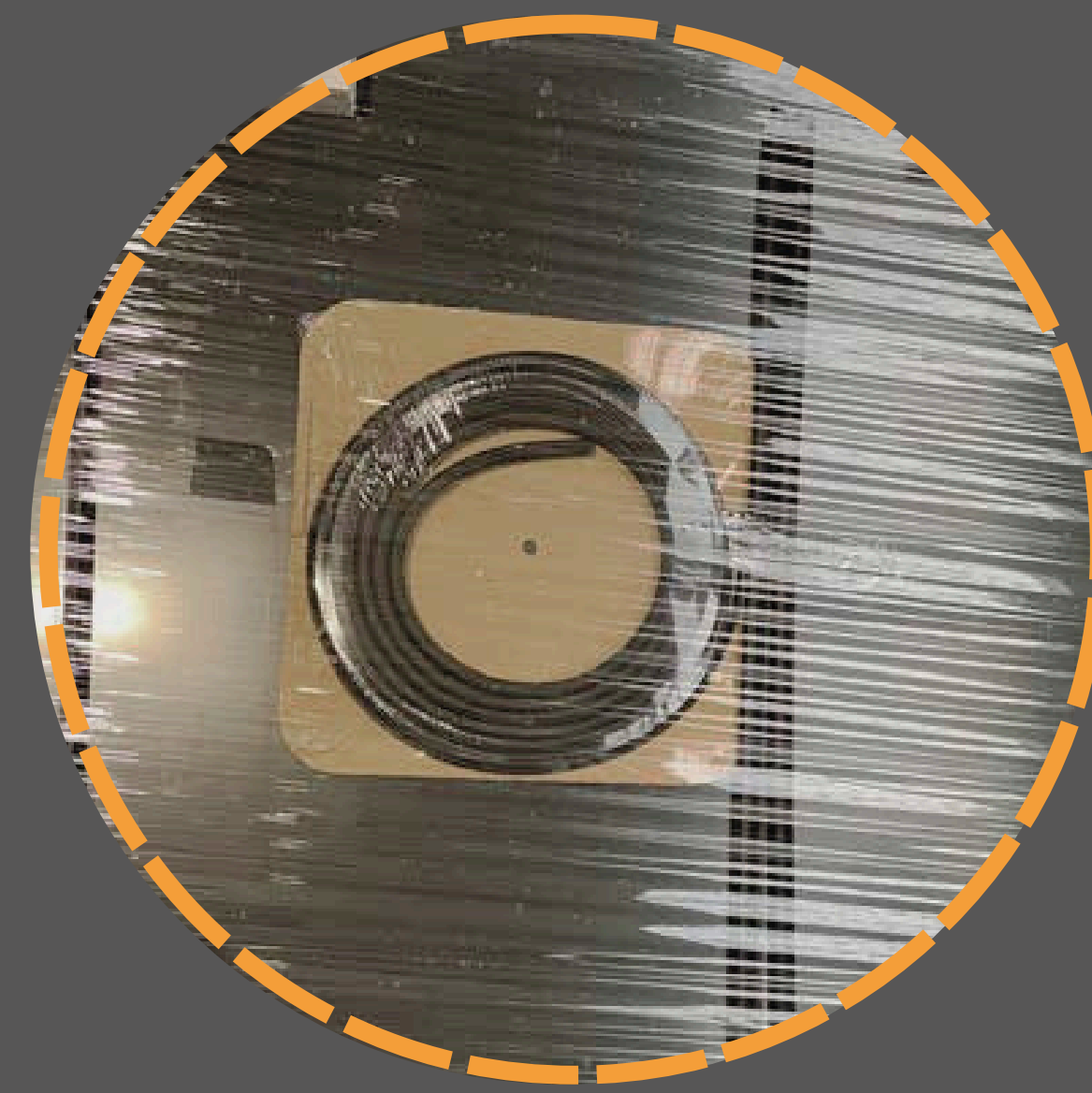

Truckload capacity: 12 pallets